



*Student Centers*  
**VANDERBILT**  
**EVENT**  
**SPACES**





# TABLE OF CONTENTS

<u>MAP</u> .....	1
<u>ALUMNI HALL</u> .....	2
• 202 MEMORIAL HALL.....	3
• 201 CLASSROOM.....	4
• 206 READING ROOM.....	5
• OUTDOOR SPACES.....	6
<u>KISSAM CENTER</u> .....	7
• C105 MEETING ROOM.....	8
• C216 CLASSROOM.....	9
• C210 MULTI-PURPOSE ROOM.....	10
• MOORE A109 & A117.....	11
<u>SARRATT RAND CENTER</u> .....	12
• CINEMA.....	13
• SARRATT 189.....	14
• SARRATT 208.....	15
• SARRATT 325/327.....	16
• PROMENADE.....	17
• GALLERY.....	17
• RAND 306.....	18
• RAND 308.....	18



# TABLE OF CONTENTS

<u>STUDENT LIFE CENTER</u>	19
• COMMODORE BALLROOM	20
• BALLROOM DIVISIONS	21
• BOARD OF TRUST	22
• MEETING ROOMS 1&2	23
• MEETING ROOM 3	24
<u>COMMONS CENTER</u>	25
• FIRESIDE LOUNGE	26
• MULTI-PURPOSE ROOM	27
• CONFERENCE ROOM	28
<u>E. BRONSON INGRAM</u>	29
• MULTI-PURPOSE ROOM	30
<u>ENGINEERING &amp; SCIENCE BUILDING</u>	31
• 001 CLASSROOM	32
• 044/048 CLASSROOM	33
• ESB 322	34
• ESB 360	34
• ESB 434	35
• ESB 462	35
• OTHER SPACES	36



# TABLE OF CONTENTS

## COMMUNITY EVENT SPACE.....37

- 008 MULTI-PURPOSE ROOM.....38
- 108 MULTI-PURPOSE ROOM.....38

## ROTHSCHILD COLLEGE.....39

- BLACK BOX THEATER.....40



# MAP OF EVENT SPACES

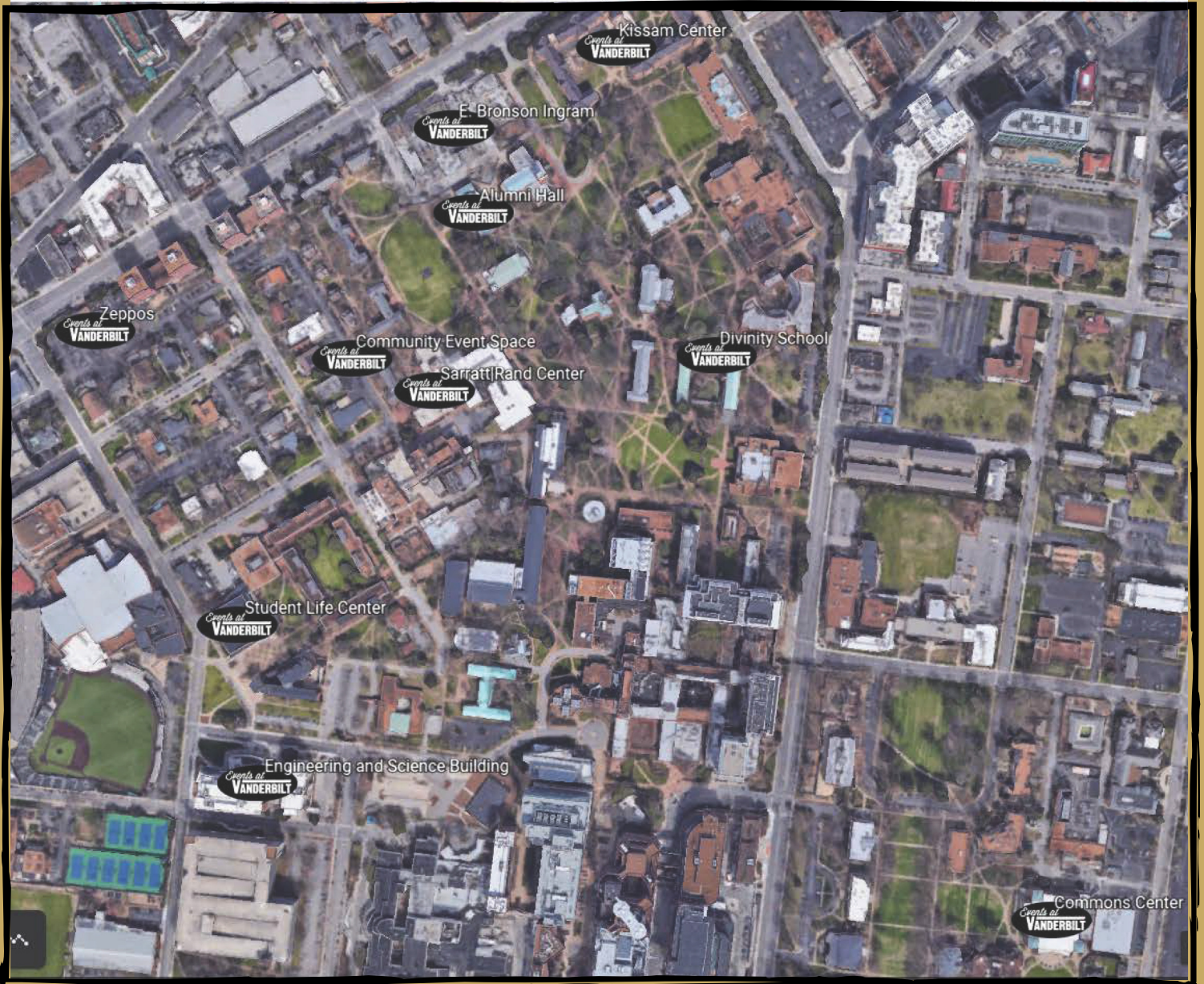



# ALUMNI HALL







# MEMORIAL HALL

1,859 SQ. FT.

Room Configurations (capacity):

Classroom (54)

Theatre (110)

Banquet (80)

2 LCD TVs

Lectern with Microphone  
and Laptop connection

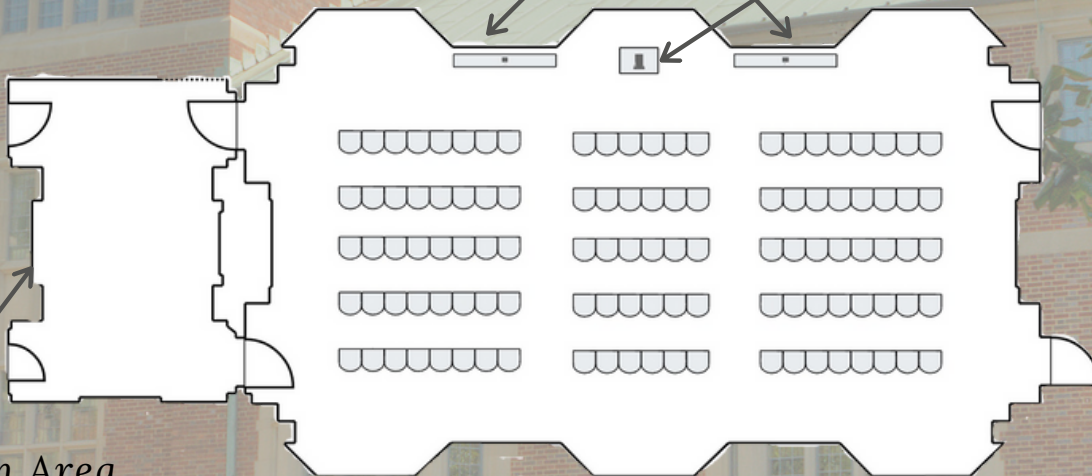

Pre- Function Area



# ALUMNI HALL



# CLASSROOM

1,772 SQ. FT.

Room Configurations (capacity):  
Classroom (66)



LCD Projector and Screen

Lectern with Microphone  
and Laptop connection

Built in  
power outlets

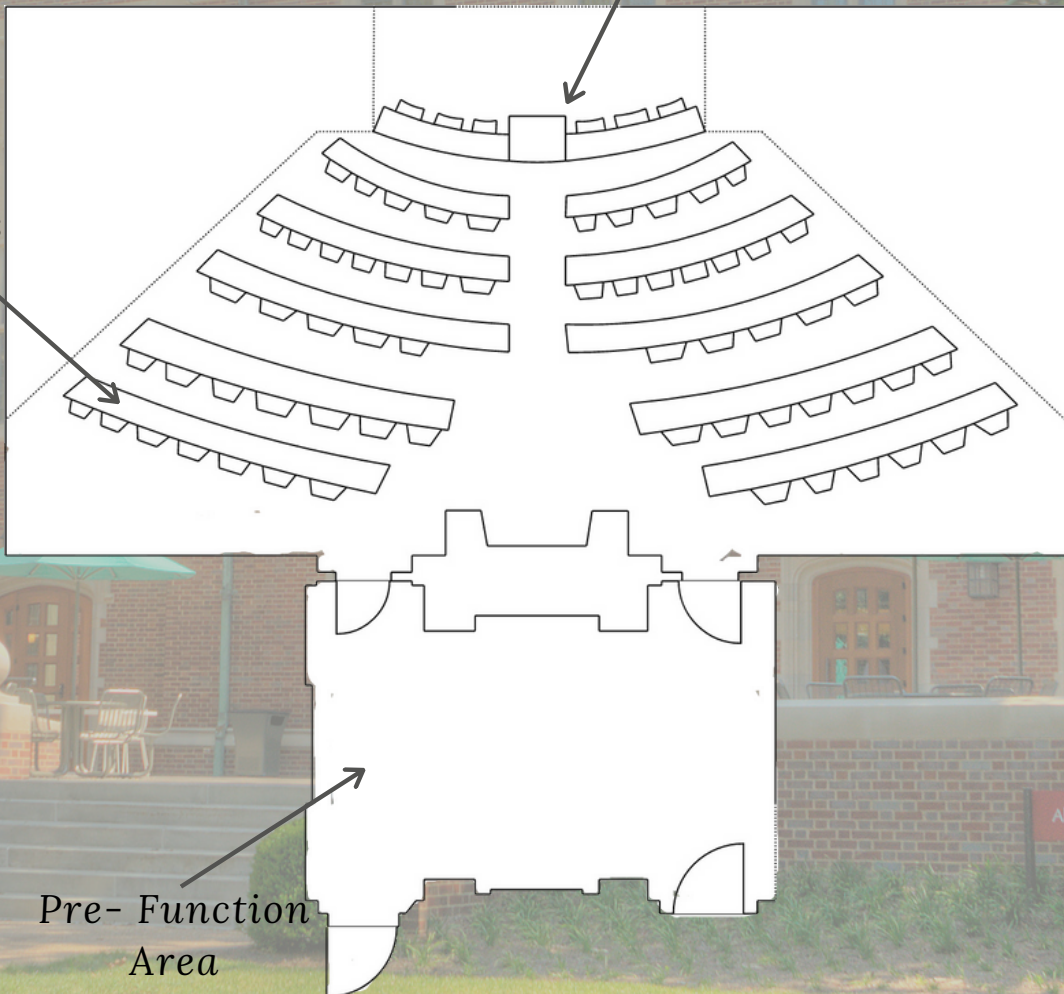

Pre-Function  
Area

ALUMNI HALL



# READING ROOM

1,783 SQ. FT.

Room Configurations (capacity):

Classroom (54)

Theatre (70)

Banquet (64)

Conference (22)

Reception (75)



Lectern with Microphone  
and Laptop connection

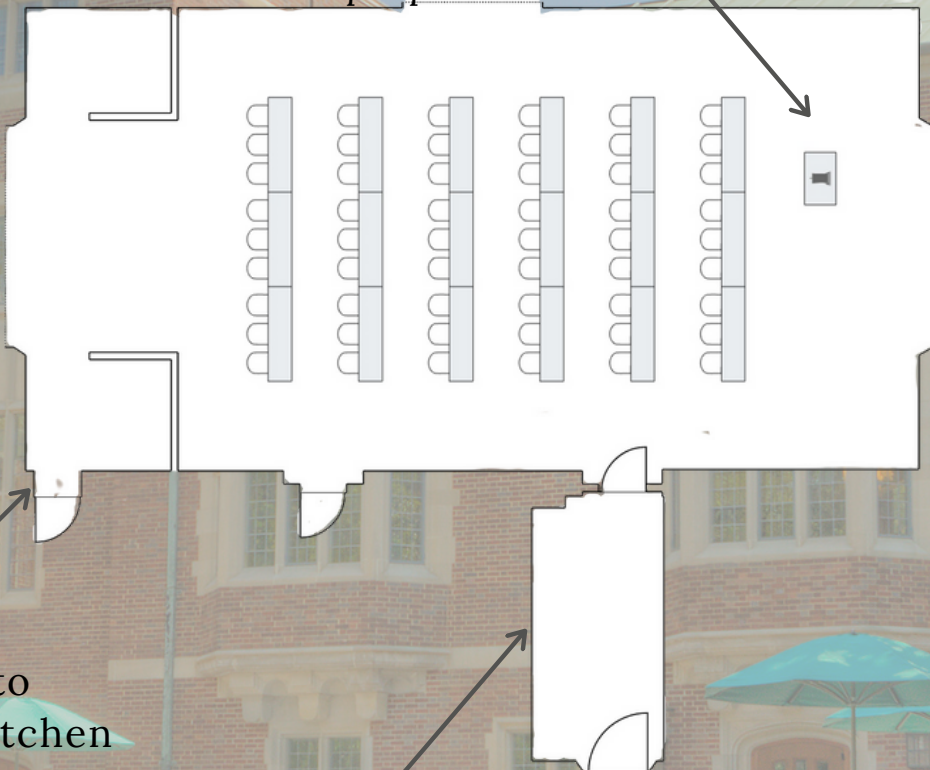

LCD Projector  
and Screen

Access to  
Catering Kitchen

Pre- Function Area



## ALUMNI HALL

Student Centers  
**VANDERBILT**



# OTHER SPACES

## TERRACE

(Cannot be rent individually)

**1,509 SQ. FT.**

Room Configurations  
(capacity):  
Multi-Purpose (75)



## NORTH TERRACE

(Cannot be rent individually)

Room Configurations  
(capacity):  
Multi-Purpose ()



ALUMNI HALL



# KISSAM CENTER

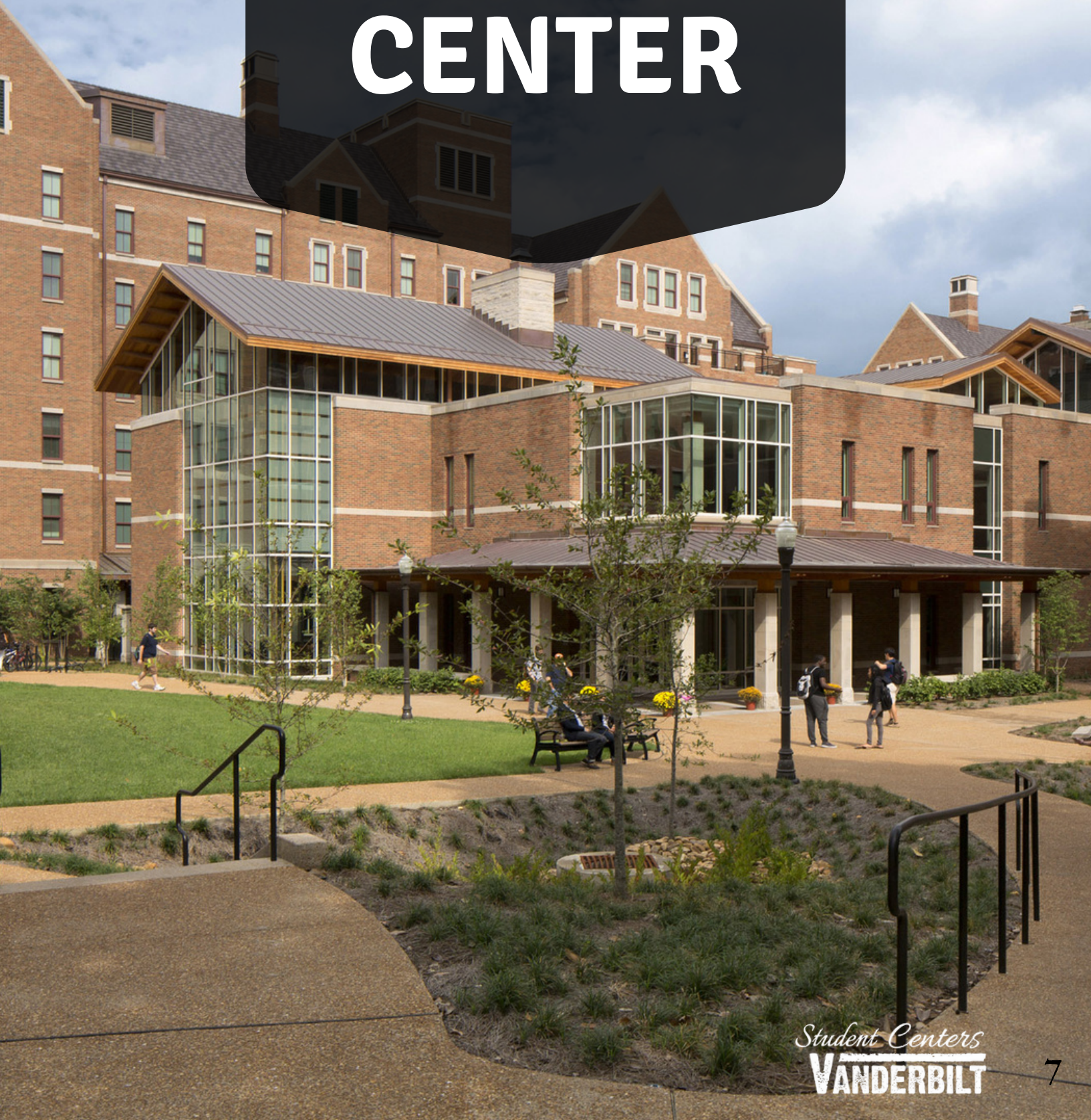





# KISSAM C105

**237 SQ. FT.**

Room Configurations (capacity):  
Conference (12)

White Board

LCD Projector and Screen

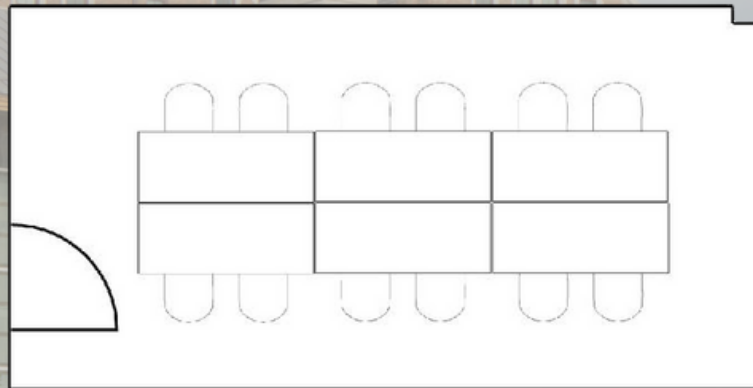





# KISSAM C<sub>216</sub> CLASSROOM

**1,446 SQ. FT.**

Room Configurations (capacity):  
Classroom (60)

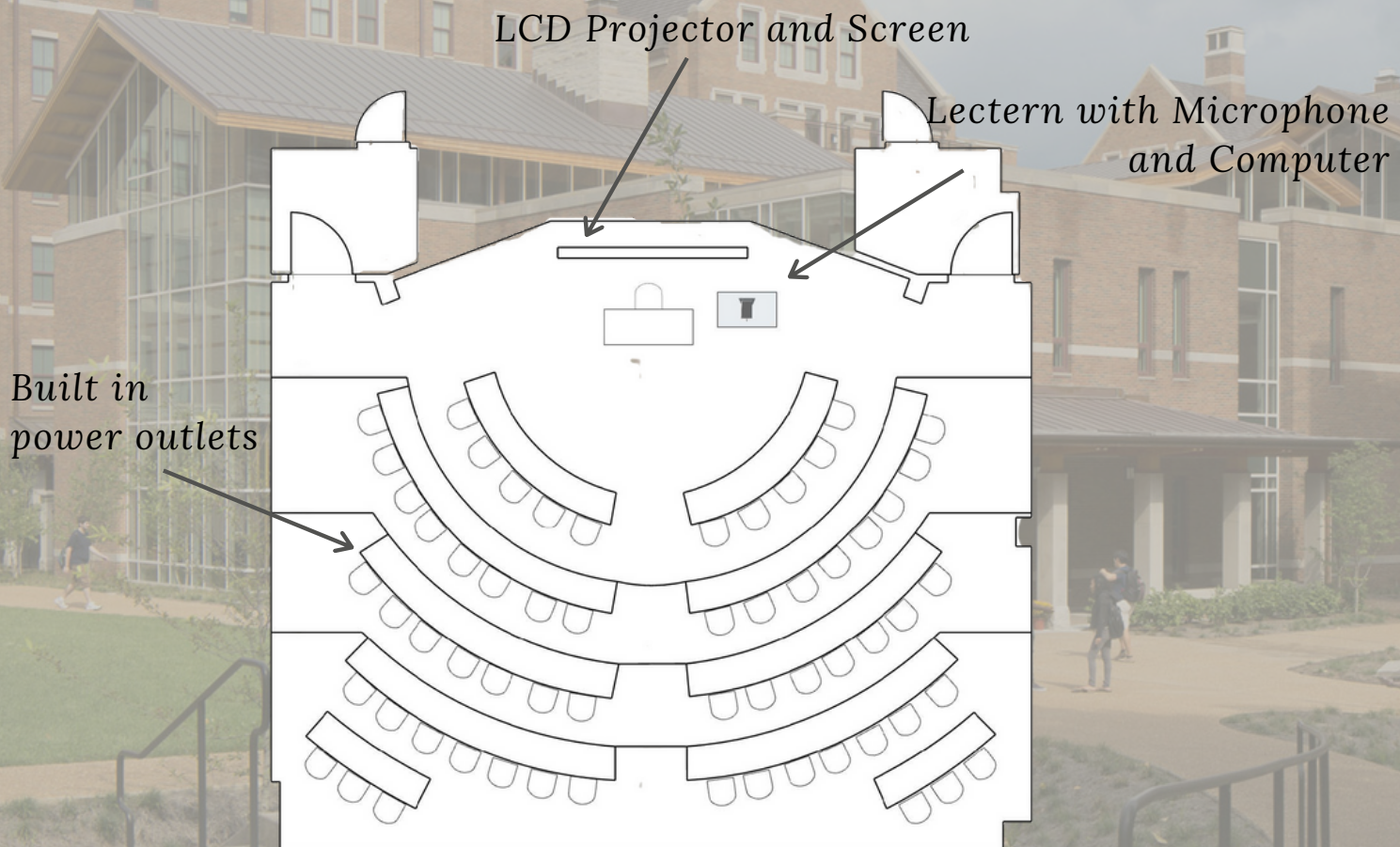





# KISSAM C<sub>210</sub> MULTI-PURPOSE ROOM

**1,469 SQ. FT.**

Room Configurations (capacity):

Classroom (50)

Conference (36)

Pods (64)

Theatre (74)

U- Shape (28)

LCD Projector and Screen

Lectern with Microphone  
and Laptop connection

Room can be  
split

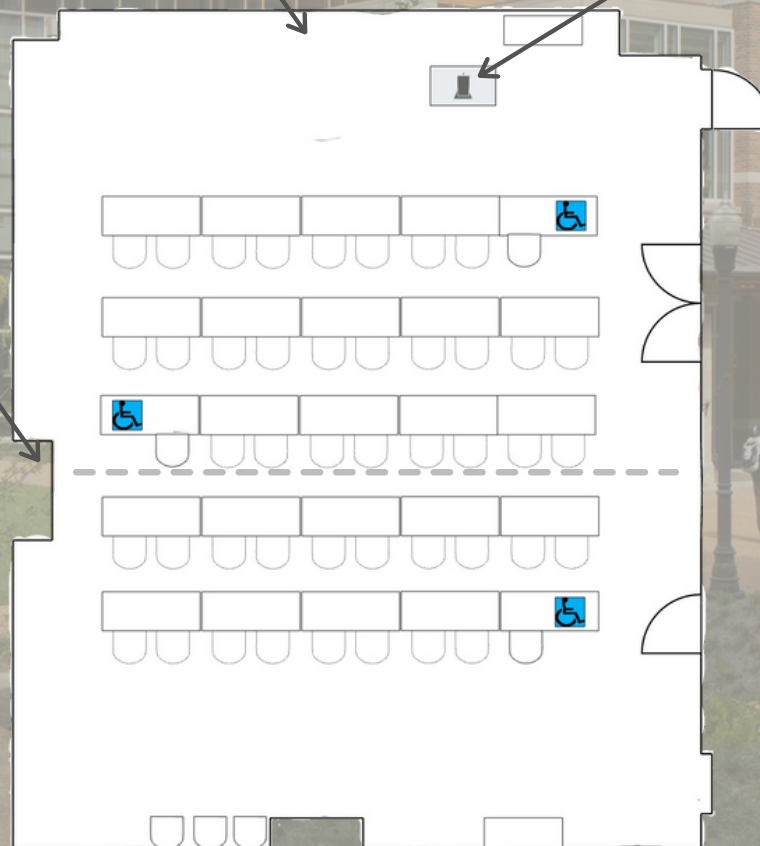

KISSAM CENTER

Student Centers  
**VANDERBILT**

10



# MOORE A109

**276 SQ. FT.**

Room Configurations (capacity):  
Conference (12)



White Board

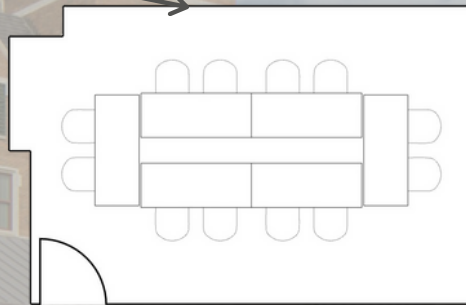

LCD Projector and Screen

# MOORE A117

**678 SQ. FT.**

Room Configurations (capacity):  
Conference (20)  
Classroom (20)  
Theatre (36)  
U- Shape (18)



White Board

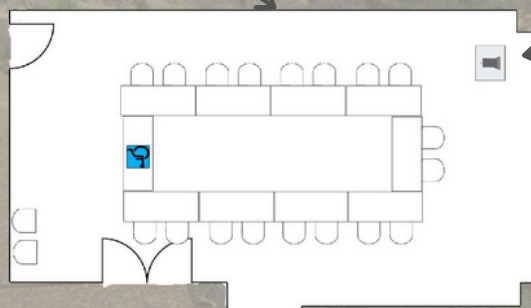

Lectern with Laptop connection

LCD Projector and Screen

KISSAM CENTER



# SARRATT|RAND CENTER







# CINEMA

**3,354 SQ. FT.**

Room Configurations (capacity):  
Theatre (296)

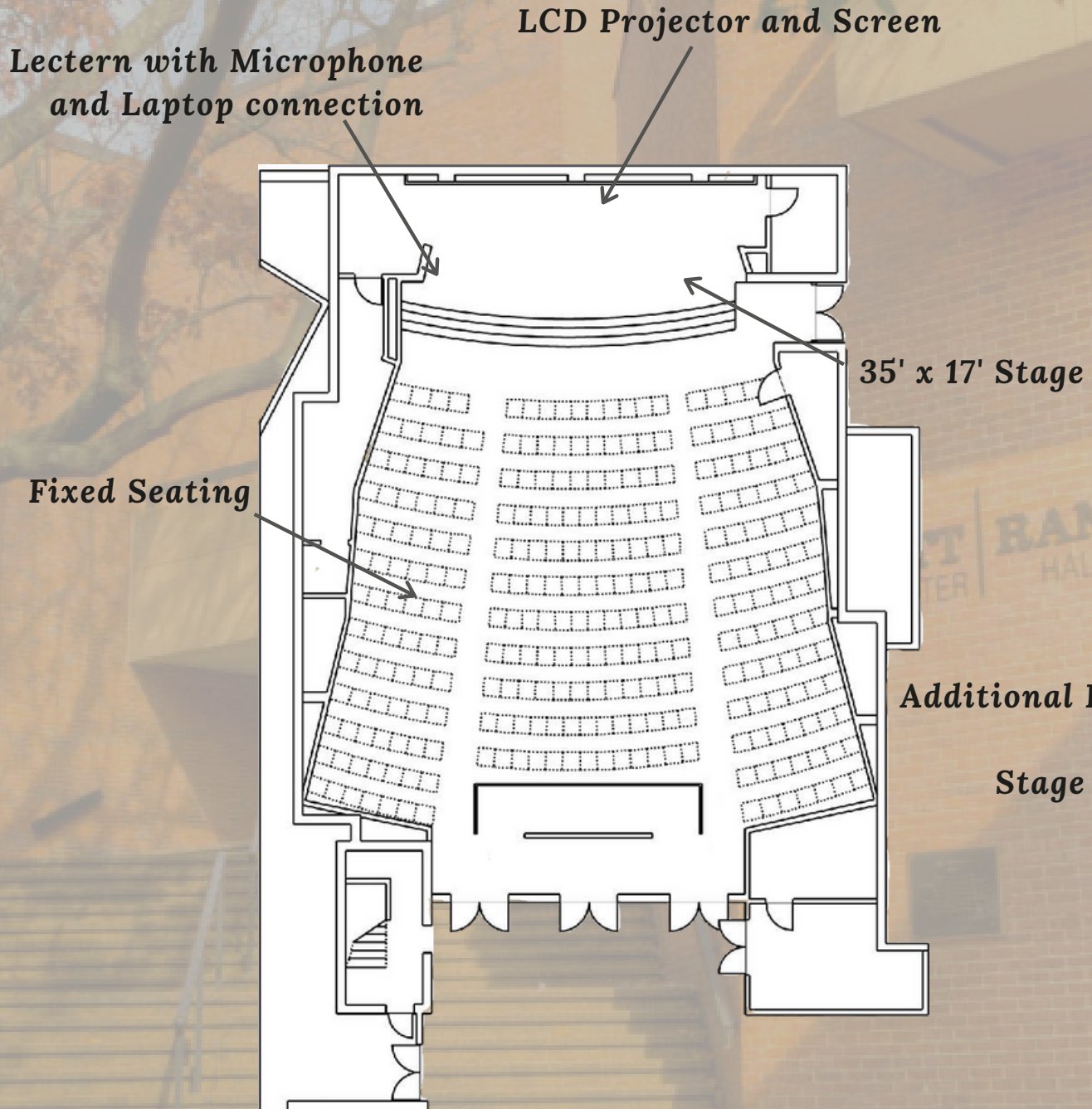





**SARRATT 189**

**918 SQ. FT.**

*Room Configurations (capacity).*

*Classroom (44)*

*Conference (36)*

*Pods (36)*

*Theatre (65)*

*U- Shape (24)*

**LCD TV with Laptop connection**

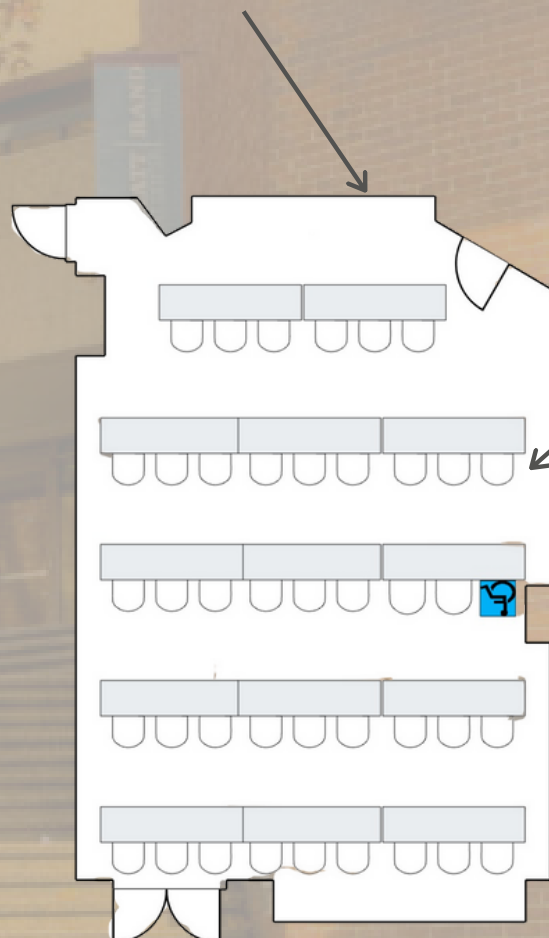

**White Board**



# SARRATT 208

**325 SQ. FT.**

*Room Configurations (capacity):  
Conference (10)*



**LCD TV with Laptop connection**

**Additional Features:  
Conference phone upon request**

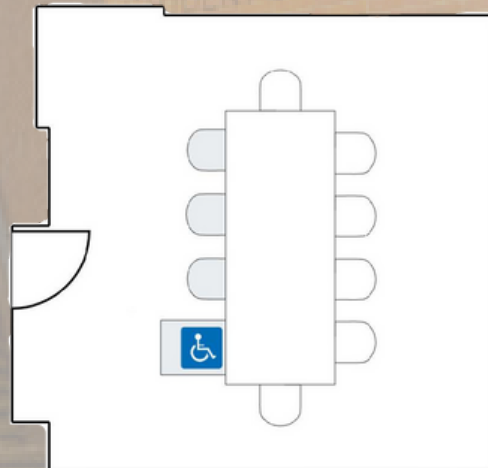



# SARRATT 325/327

**1,162 SQ. FT.**

**Room Configurations (capacity):**

Classroom (42)

Banquet (42)

Conference (42)

Reception (75)

Theatre (65)

U- Shape (32)



**Room can be split**

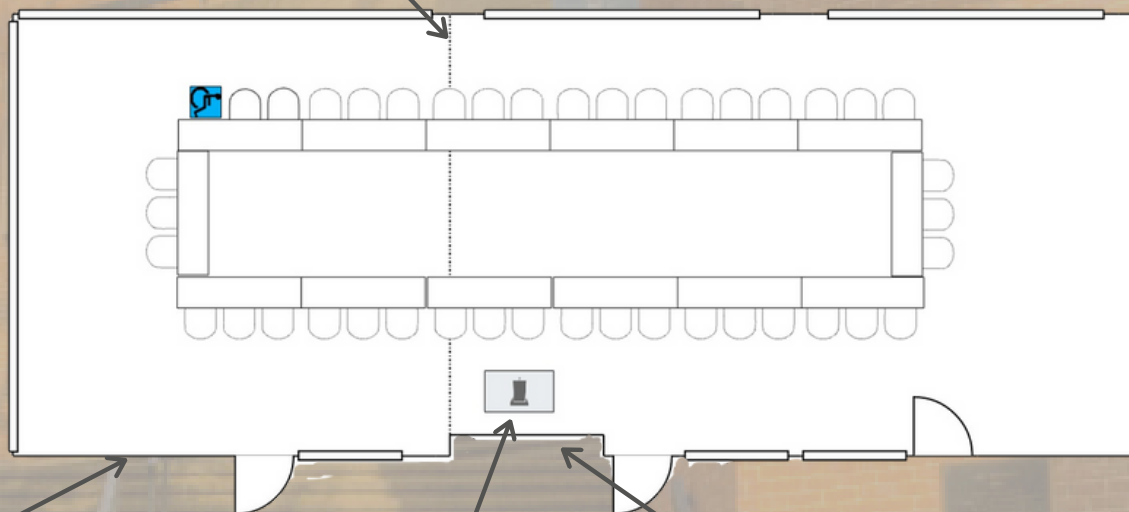

**LCD TV**

**Lectern with Microphone  
and Laptop connection**

**LCD TV**

**LCD TV**





# PROMENADE

4,251 SQ. FT.

Room Configurations (capacity):  
Reception (150)

# GALLERY

2,800 SQ. FT.

Room Configurations (capacity):  
Multi-Purpose (100)  
Connected to the Cinema





# RAND 306

496 SQ. FT.

Room Configurations (capacity):  
Conference (14)

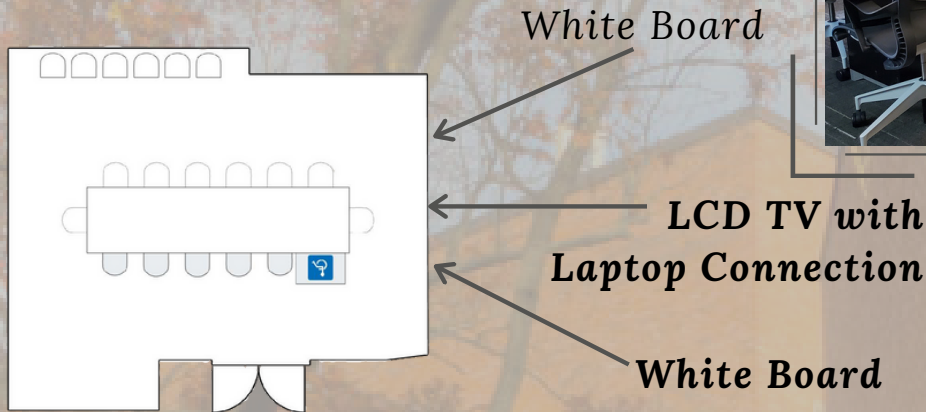

# RAND 308

1,169 SQ. FT.

Room Configurations (capacity):  
Classroom (40)  
Conference (32)  
Pods (48)  
Reception (100)  
Theatre (84)  
U- Shape (26)

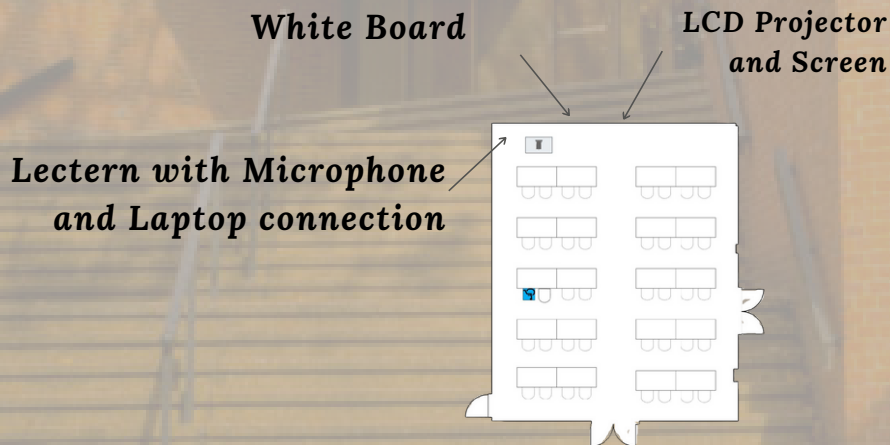



# STUDENT LIFE CENTER





# COMMODORE BALLROOM

**9,000 SQ. FT.**

Room Configurations (capacity):

Banquet (304)

Theatre (558)

Classroom (300)

Reception (800)

**LCD Projectors and Screens**

**4' x 8' Stage Sections**

**Access to  
Catering Kitchen**

**Pre- Function Area**

**Additional Features:**  
Pipe and Drape  
Stage Lighting  
Specialty Lighting



# BALLROOM DIVISIONS

## BALLROOM A

**3,700 SQ. FT.**

Room Configurations (capacity):

Banquet (96)

Classroom (126)

Theatre (192)

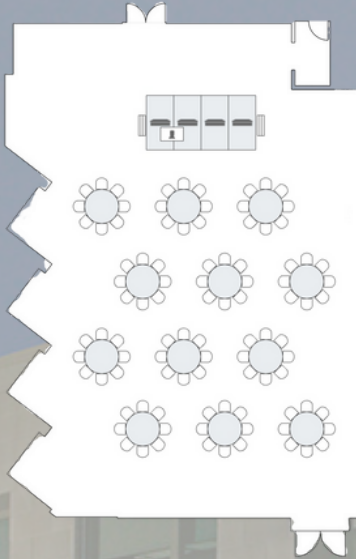

## BALLROOM C

**2,700 SQ. FT.**

Room Configurations (capacity):

Banquet (64)

Classroom (84)

Theatre (108)

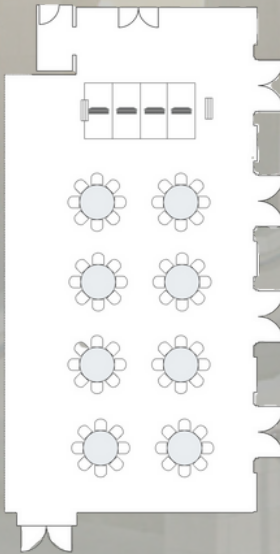



# BOARD OF TRUST

**2,550 SQ. FT.**

*Room Configurations (capacity):*

*Classroom (60)*

*Theatre (194)*

*Banquet (80)*



**LCD Projector and Screen**

**Lectern with Microphone  
and Laptop connection**

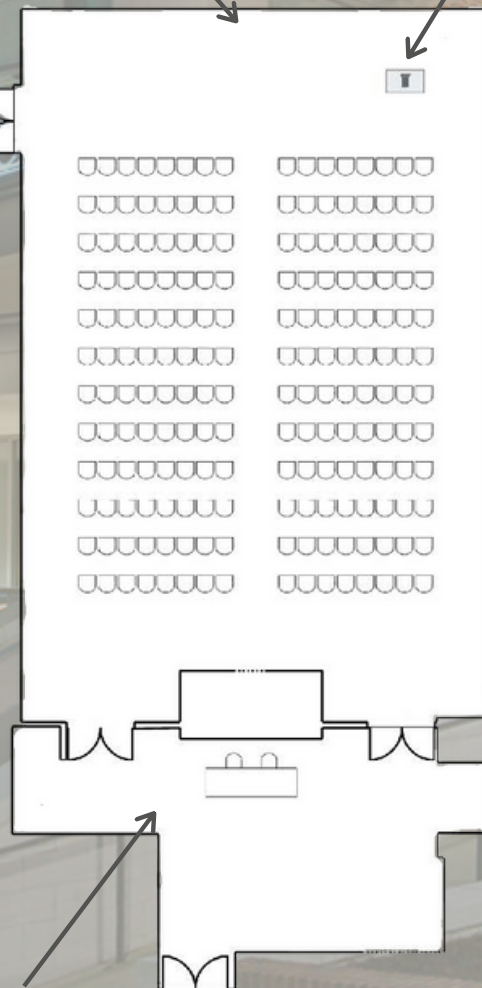

**Pre- Function Area**



# MEETING ROOMS

I & 2

1,160 SQ. FT.

Room Configurations (capacity):

Classroom (40)

Theatre (82)

Banquet (56)

U- Shape (44)



Lectern with Microphone  
and Laptop connection

LCD Projector and Screen

Room can be split

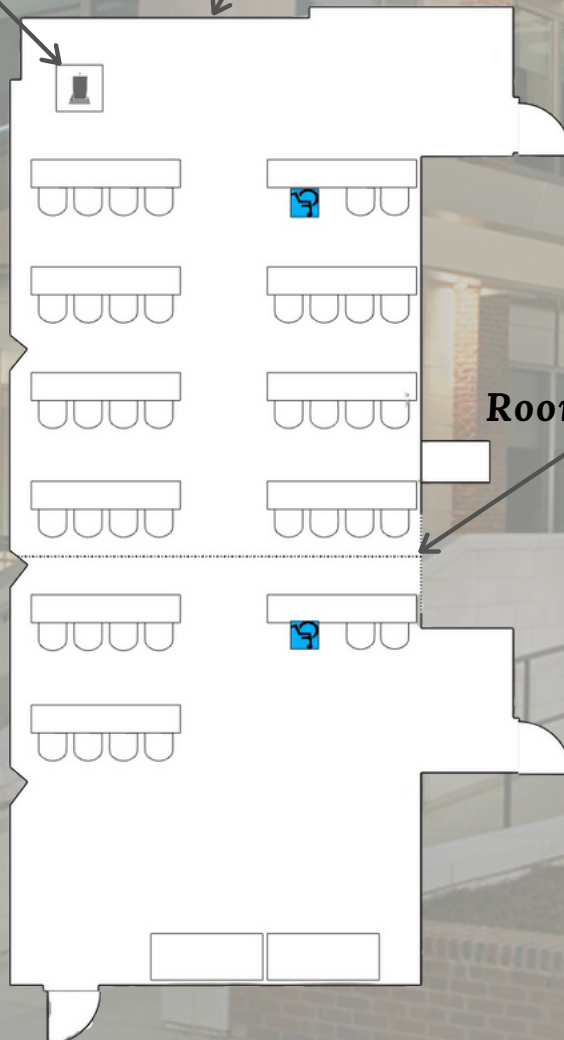





# MEETING ROOM 3

**460 SQ. FT.**

*Room Configurations (capacity):*

*Classroom (15)*

*Theatre (24)*

*Conference (24)*

*U- Shape (20)*

**Lectern with Microphone  
and Laptop connection**

**LCD Projector and Screen**

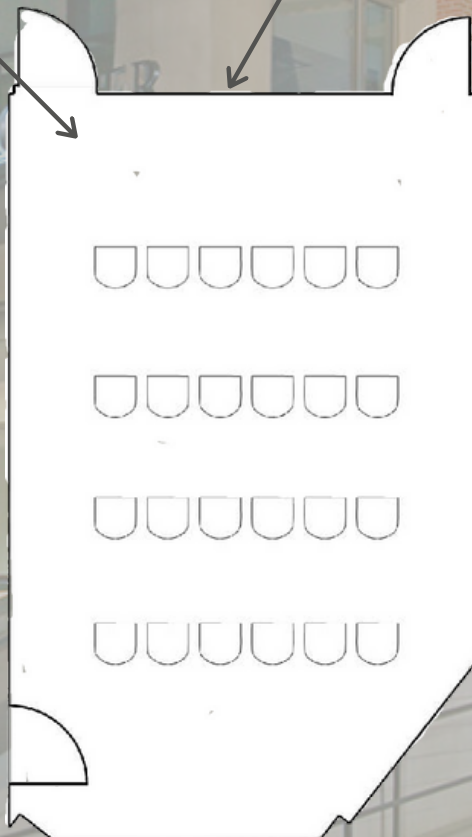



# COMMONS CENTER

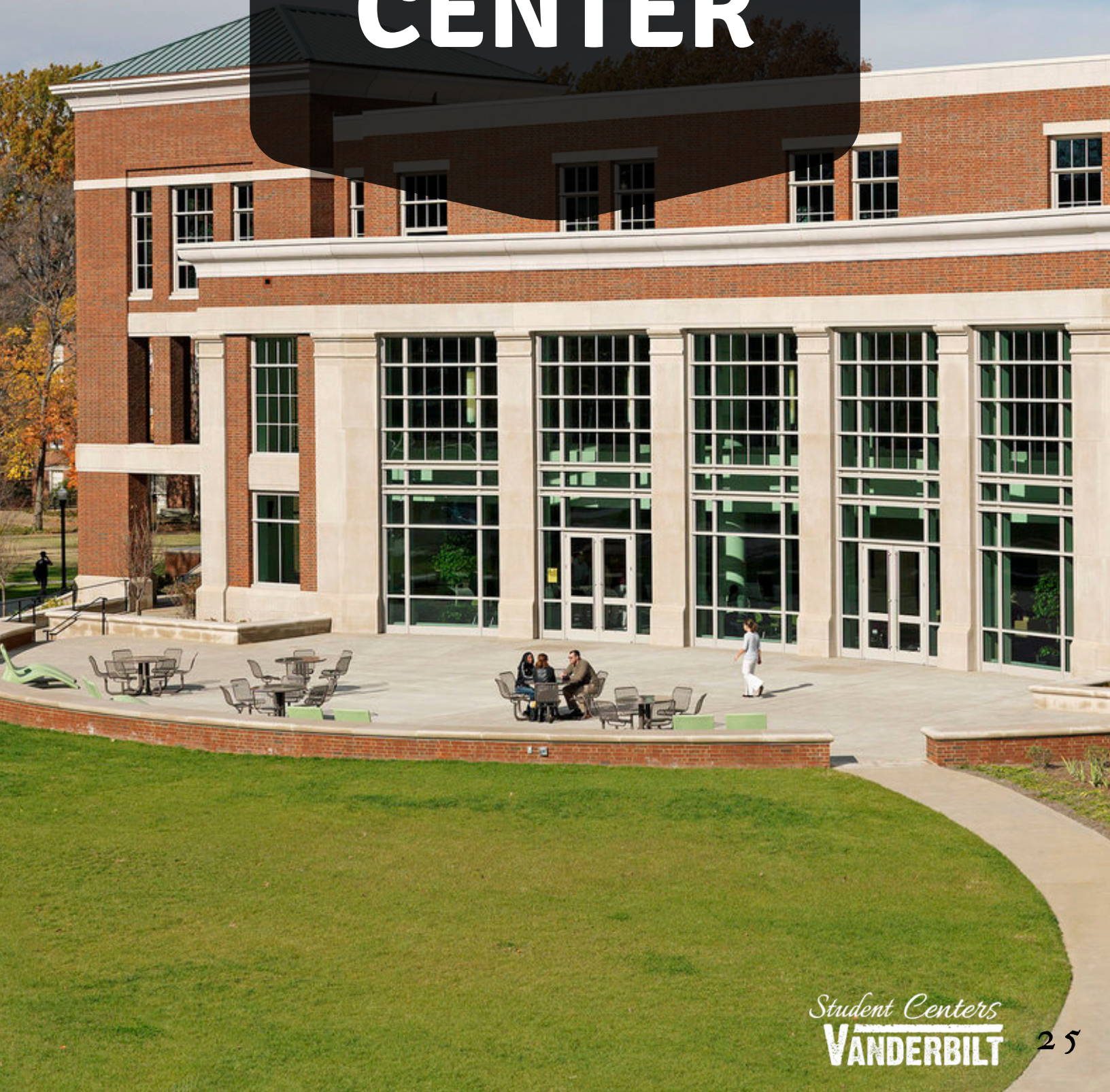





# FIRESIDE LOUNGE

**434 SQ. FT.**

*Room Configurations (capacity):*

*Multi-Purpose (12)*

*Theatre (12)*

*Reception (25)*



# LOBBY

**2,812 SQ. FT.**

*Room Configurations (capacity):*

*Multi-Purpose (36)*

*Reception (36)*



# COMMONS CENTER



# MULTI-PURPOSE ROOM

**2,803 SQ. FT.**

*Room Configurations (capacity):*

*Classroom (72)*

*Banquet (96)*

*Pods (128)*

*Conference (64)*

*Theatre (210)*

**LCD Projectors and Screens**

**Lectern with Microphone  
and Laptop connection**

**Room can be split**

**Pre- Function Area**



# CONFERENCE ROOM

**750 SQ. FT.**

*Room Configurations (capacity):*  
U- Shape (18)



**White Board**

**LCD Projector  
and Screen**

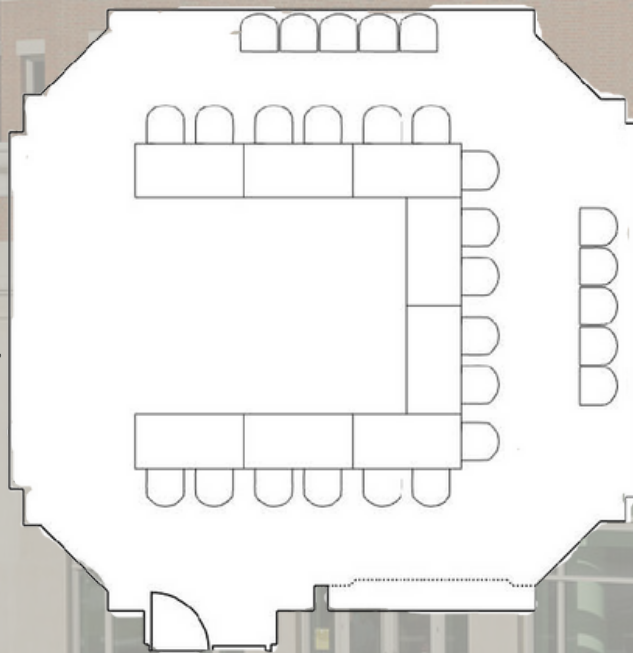





# E. BRONSON INGRAM





# 1003 MULTI-PURPOSE ROOM

**1,345 SQ. FT.**

*Room Configurations (capacity):*

*Conference (28)*

*Pods (32)*

*Classroom (32)*

*Theatre (60)*

**LCD Projector and Screen**

**Lectern with  
Microphone and  
Laptop connection**

**Room can be split**

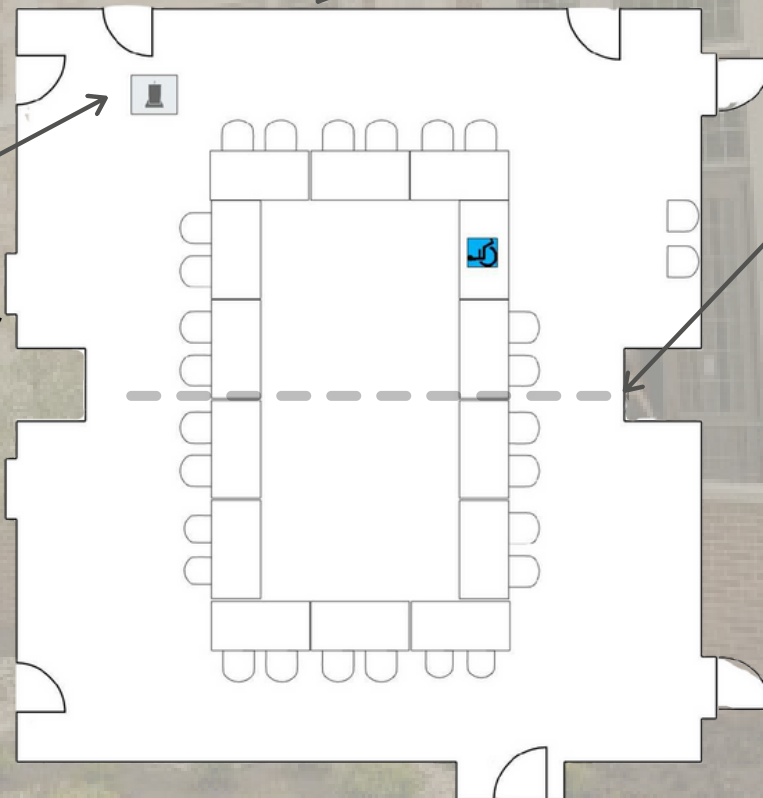



A photograph of a modern, multi-story building with a curved facade. The building features a combination of brickwork and large glass windows. The glass reflects the sky and surrounding environment. The building is set against a blue sky with scattered white clouds. In the foreground, there is a green lawn and a concrete walkway. A large, dark, hexagonal graphic is overlaid on the upper left portion of the image, containing the text 'ENGINEERING AND SCIENCE BUILDING' in white, bold, sans-serif capital letters.

# ENGINEERING AND SCIENCE BUILDING





# CLASSROOM

**787 SQ. FT.**

Room Configurations (capacity):  
Classroom (24)

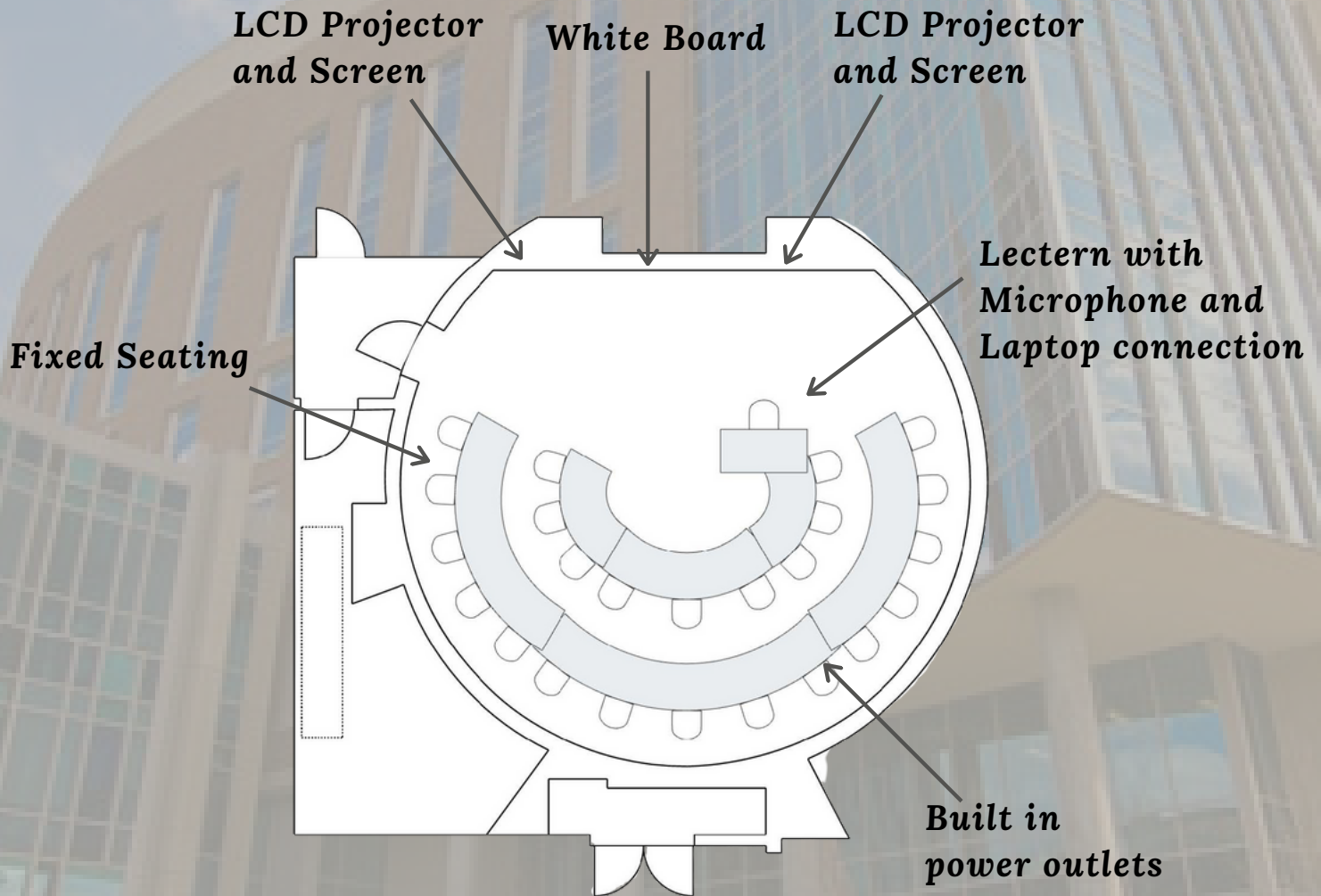





# ○44/○48 CLASSROOM

**2,670 SQ. FT.**

Room Configurations (capacity):

Classroom (120)

Theatre (120)

Hollow Square (68)

U- Shape (72)

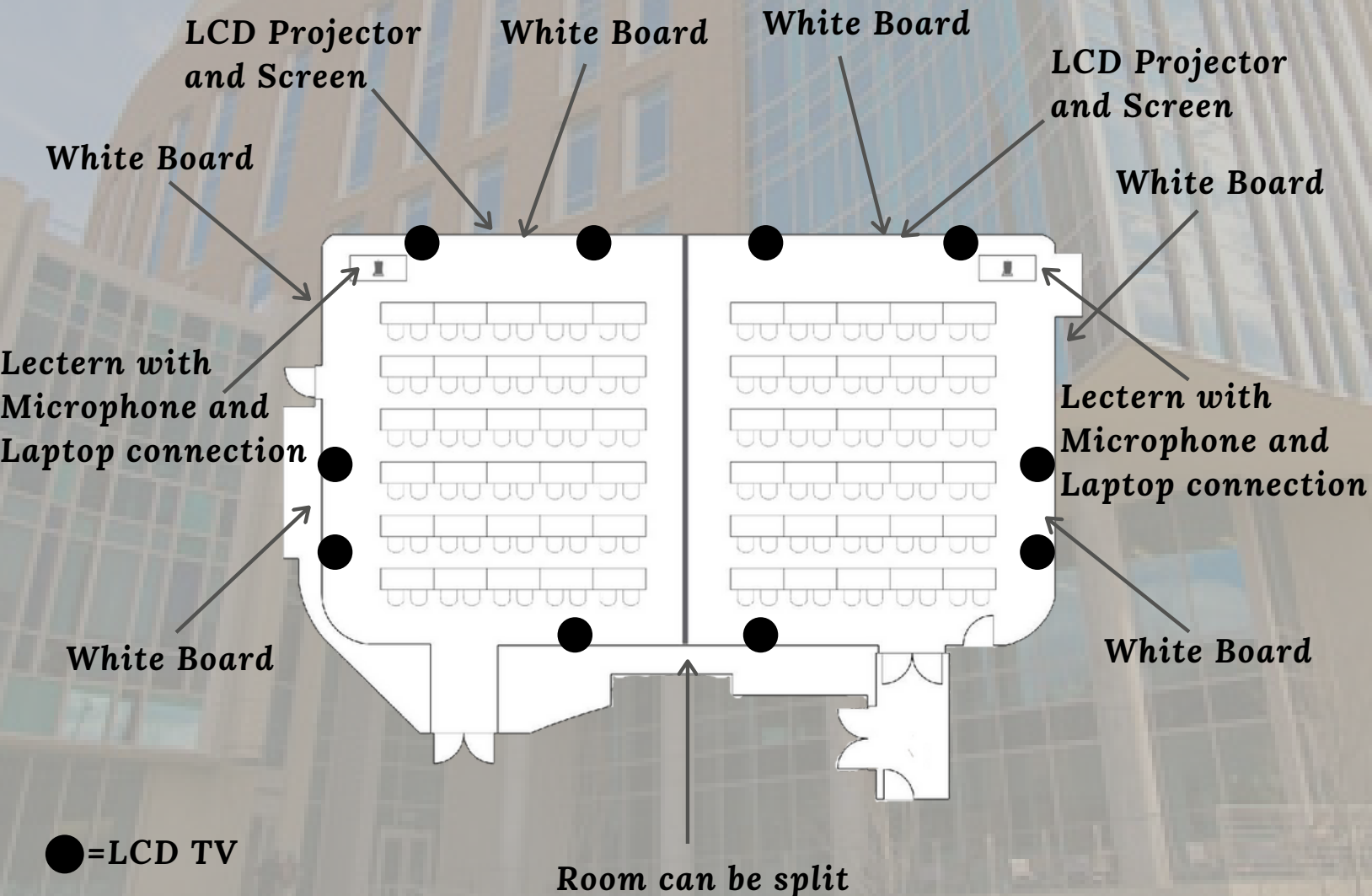



ESB 322

217 SQ. FT.

Room Configurations (capacity):  
Conference (8)



LCD TV with  
Laptop  
connection

White Board

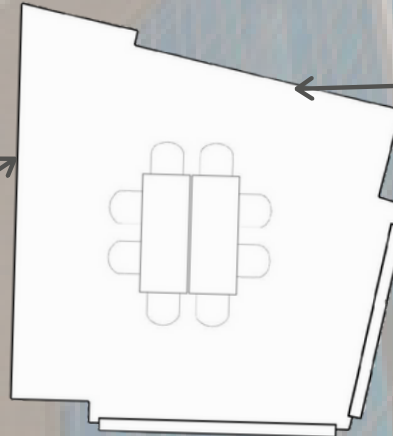

ESB 360

603 SQ. FT.

Room Configurations (capacity):  
Conference (16)  
Classroom (18)



White Board

LCD Projector  
and Screen

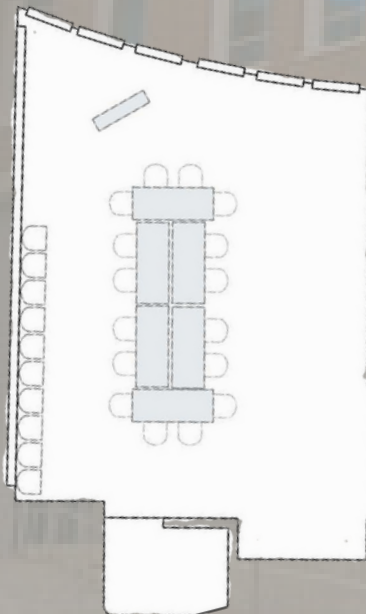



ESB 434

603 SQ. FT.

Room Configurations (capacity):  
Conference (16)  
Classroom (18)

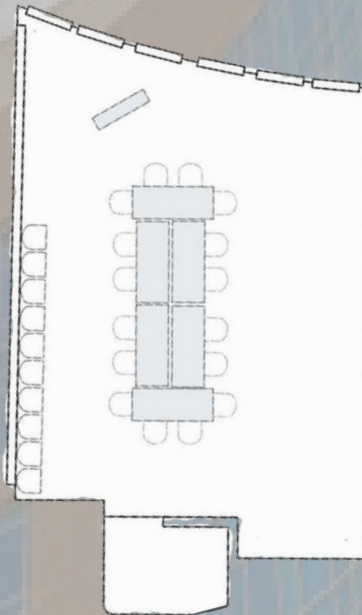

White Board

LCD Projector  
and Screen

ESB 462

274 SQ. FT.

Room Configurations (capacity):  
Conference (12)

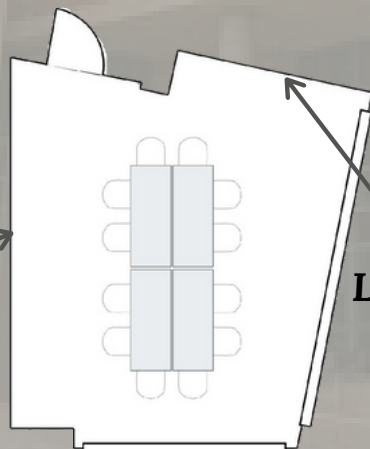

White Board

LCD TV with Laptop connection



# OTHER SPACES

## MPR LOBBY

**1,985 SQ. FT.**

Room Configurations (capacity):  
Multi-Purpose (100)  
Booked with MPR 044/048



## MAIN LOBBY

**3,750 SQ. FT.**

Room Configurations (capacity):  
Multi-Purpose (200)



## TERRACE

**1,027 SQ. FT.**

Room Configurations (capacity):  
Multi- Purpose (100)



# ENGINEERING & SCIENCE BUILDING



# COMMUNITY EVENT SPACE





# 108 MULTI-PURPOSE ROOM

1,786 SQ. FT.

Room Configuration (capacity):  
Multi-Purpose (100)



# 108 MULTI-PURPOSE ROOM

1,812 SQ. FT.

Room Configuration (capacity):  
Multi-Purpose (100)



COMMUNITY EVENT SPACE



# ROTHSCHILD COLLEGE

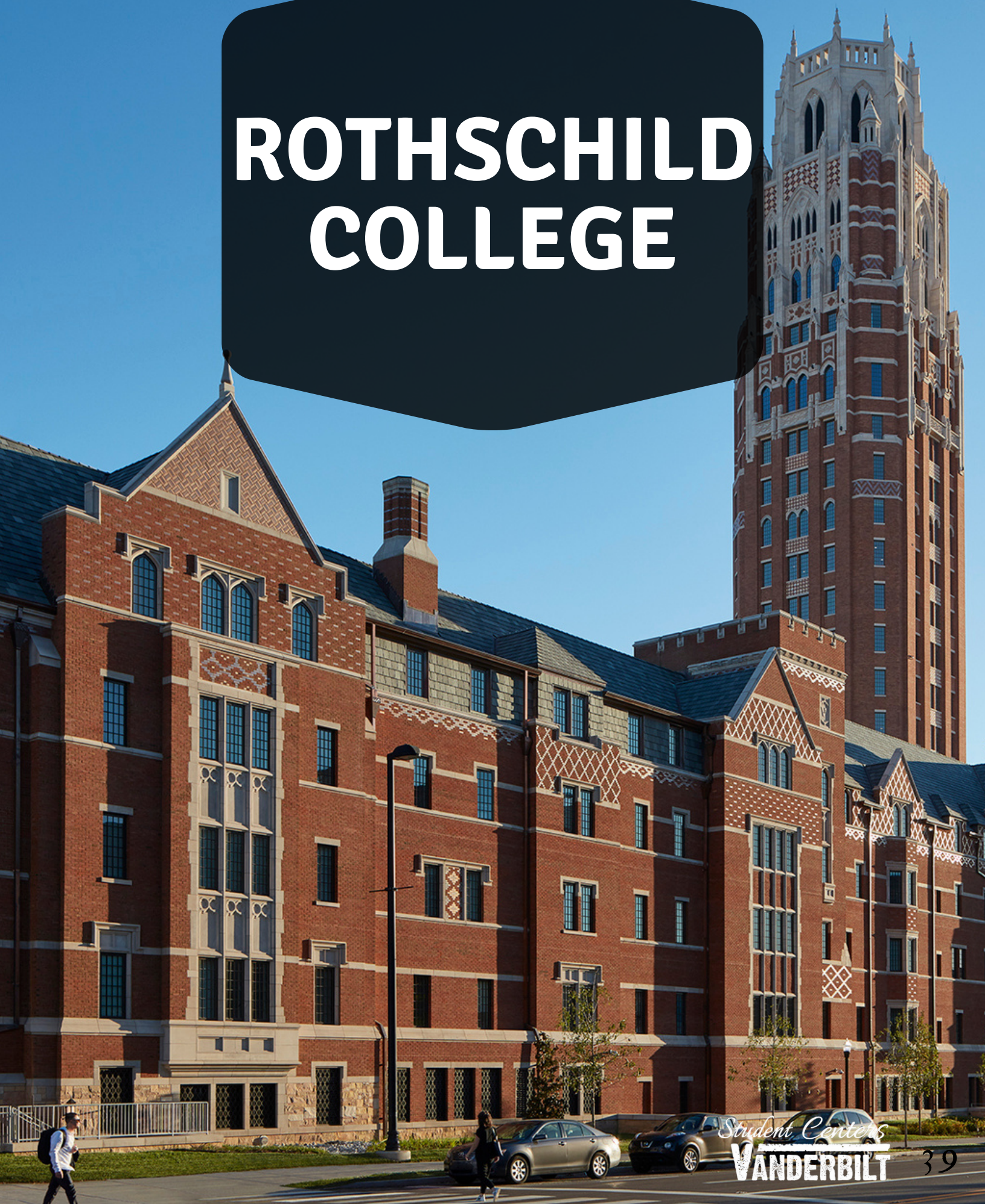





# BLACK BOX THEATER

**1,167 SQ. FT.**

Room Configurations (capacity):  
Theatre (72)



# CONFERENCE ROOM

**385 SQ. FT.**

Room Configurations (capacity):  
Conference setup only (14)







CONTACT US

[eventservices@vanderbilt.edu](mailto:eventservices@vanderbilt.edu)



WEBSITE

